

CLIFFORD STREET

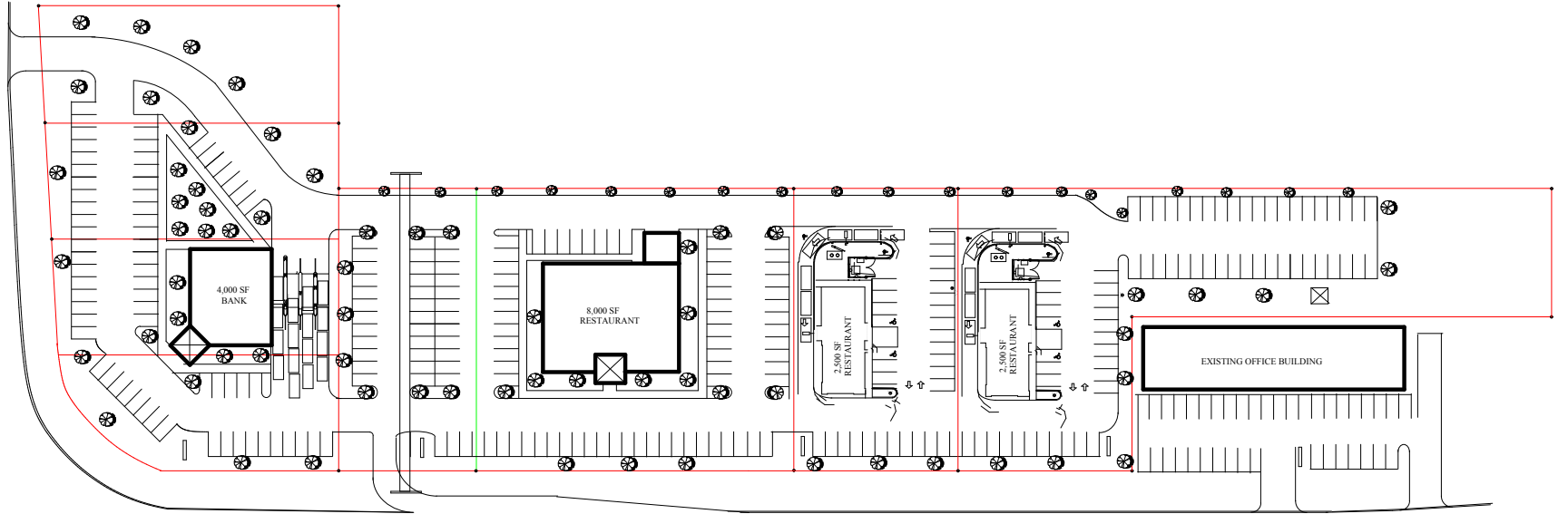

LOOP 820



©NCTCOG

Branch Cir

Clifford St

Branch Cir

CLIFFORD STREET

4,000 SF BANK

8,000 SF RESTAURANT

2,500 SF RESTAURANT

2,500 SF RESTAURANT

EXISTING OFFICE BUILDING

820

820 N

LOOP 820

820

Exit 58

820

820 N

Clifford Ave

820

820

Exit 4

138ft

http://www.dfwmaps.com